

Models MR-8, R-275, R-315

Residential Gas Meters

MP-1002A R5

SENSUS

Parts List

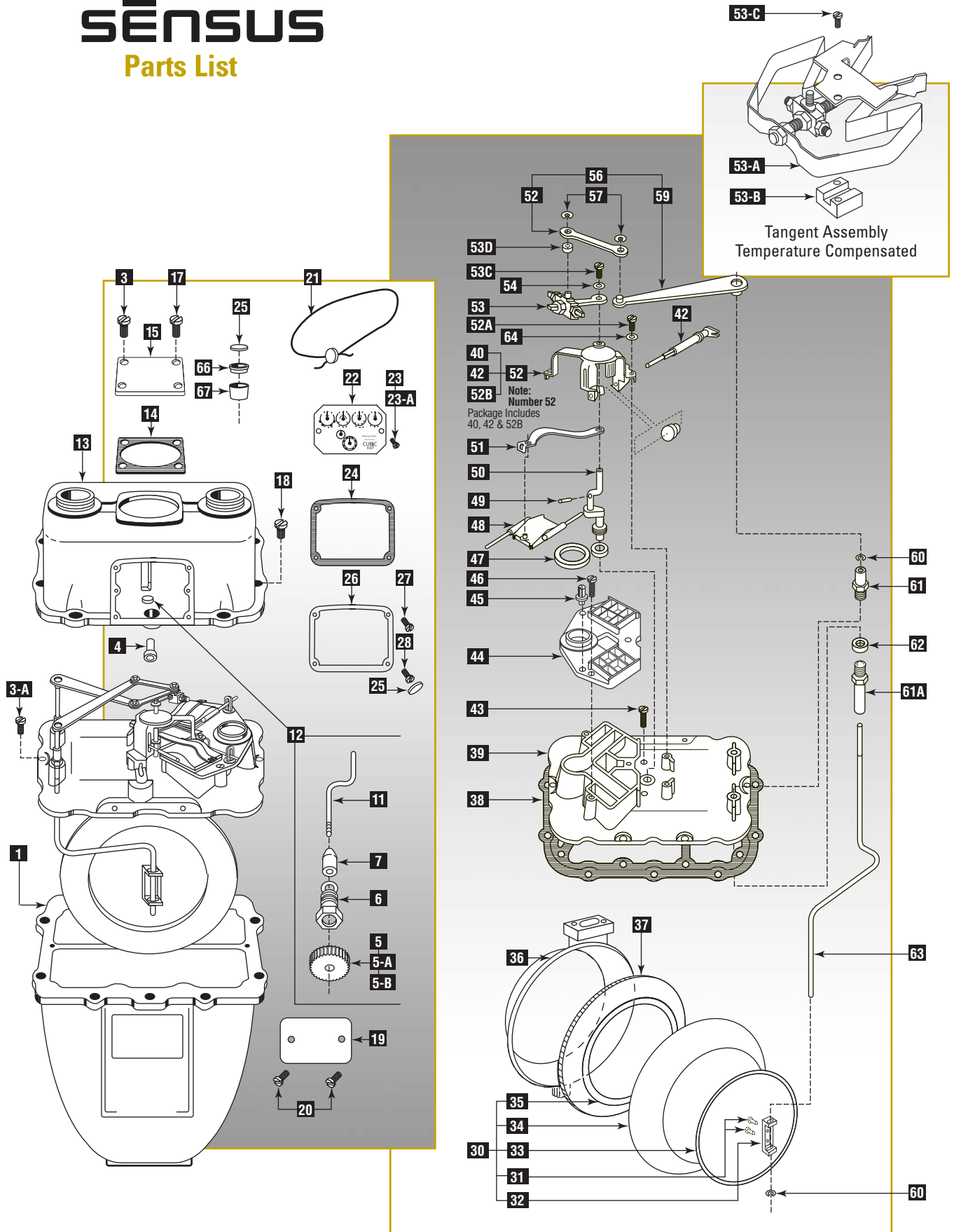

Parts List

Models MR-8, R-275, R-315 Residential Gas Meters



Illustration Number	Part Description	Part Number MR-8	Part Number R-275	Part Number R-315
1	Body, No Drains	001-63-001-29000	001-63-001-29000	001-63-001-29000
2	Valve Plate Assembly, Uncalibrated, NTC ("EB")	001-63-502-19000	001-63-502-06000	001-63-502-06000
	Valve Plate Assembly, Uncalibrated, TC ("EB")	001-63-502-20000	001-63-502-07000	001-63-502-07000
	Valve Plate Assembly, Uncalibrated, NTC accuWAVE	001-63-502-86000	001-63-502-84000	
	Valve Plate Assembly, Uncalibrated, TC accuWAVE	001-63-502-85000	001-63-502-83000	
3	Hand Hole Plate Screws, (#10-24 x 5/8")	950325	950325	950325
3A	Valve Plate Screws, (#10-24 x 7/16")	950652	950652	950652
4	Cover Index Shaft Bushing	001-60-052-62000	001-60-052-62000	001-60-052-62000
5	Index Shaft Gear (11 Teeth for 2 Ft. Index)		001-63-086-03000	001-63-086-03000
5A	Index Shaft Gear (24 Teeth for 1 Ft. Index)		001-63-086-05000	001-63-086-05000
5B	Index Shaft Gear m ³	001-63-086-18000		
6	Index Shaft Gland	001-63-023-00000	001-63-023-00000	001-63-023-00000
7	Index Shaft Seal (Synthetic)	001-63-350-01000	001-63-350-01000	001-63-350-01000
11	Stuffing Box Shaft	001-63-054-05000	001-63-054-05000	001-63-054-05000
	Stuffing Box Luubricant	951139	951139	951139
	Stuffing Box Assembly (24 T. Gear for 1 Ft. Index)		001-63-423-25000	001-63-423-25000
12	Stuffing Box Assembly (11 T. Gear for 2 Ft. Index)		001-63-423-22000	001-63-423-22000
	Stuffing Box Assembly (m ³ 16 T)	00163-423-26000		
13	Cover Assemblies, 5 psig Test			
	Cover Assembly (1-1/4" Spuds, 24 T. Gear for 1 Ft. Index)		001-63-203-78000	001-63-223-70000
	Cover Assembly (#1A Sprague, 24 T. Gear for 1 Ft. Index)		001-63-203-79000	001-63-223-72000
	Cover Assembly (30 Lt. Spuds, 11 T. Gear for 2 Ft. Index)		001-63-203-61000	001-63-223-54000
	Cover Assembly (1-1/4" Spuds, 11 T. Gear for 2 Ft. Index)		001-63-203-62000	001-63-223-55000
	Cover Assembly (20 Lt. Spuds, 11 T. Gear for 2 Ft. Index)		001-63-203-63000	001-63-223-56000
	Cover Assembly (#2 Sprague, 11 T. Gear for 2 Ft. Index)		001-63-203-66000	001-63-223-58000
	Cover Assembly (10 Lt. Spuds, 11 T. Gear for 2 Ft. Index)		001-63-203-64000	001-63-223-60000
	Cover Assembly (#1A Sprague, 11 T. Gear for 2 Ft. Index)		001-63-203-65000	001-63-223-57000
	Cover Assembly (45 Lt. Spuds, 11 T. Gear for 2 Ft. Index)			001-63-223-59000
	Cover Assemblky (30 Lt., 24 T. Gear for 1 Ft. Index)		001-63-203-81000	001-63-223-62000
	Cover Assembly (20 Lt., 24 T. Gear for 1 Ft. Index)		001-63-203-80000	001-63-223-64000
	Cover Assembly (10 Lt., 24 T. Gear for 1 Ft. Index)		001-63-203-89000	001-63-223-82000
	20 Lt. Cover MR-8	001-63-223-00000		
	30 Lt. Cover MR-8	001-63-223-01000		
	10 Lt. Cover MR-8	001-63-223-02000		
	1-1/4" Cover MR-8	001-63-223-04000		
#1A Sprague Cover MR-8	001-63-223-03000			
14	Hand Hole Plate Gasket (Cork Rubber)	001-63-160-50000	001-63-160-50000	001-63-160-50000
15	Hand Hole Plate	001-60-004-00000	001-60-004-00000	001-60-004-00000
17	Hand Hole Plate Screw (#10-24 x 5/8" Fillister Head Drilled)	001-60-056-06000	001-60-056-06000	001-60-056-06000
18	Cover Screws (1/4 - 20 x 3/4" Fillister Head Machined)	950327	950327	950327
19	Customers Nameplate	001-41-030-21000	001-41-030-21000	001-41-030-21000
	Manufacturers Nameplate, NTC 5#	001-63-030-76555	001-63-030-66555	001-63-030-67555
	Manufacturers Nameplate, TC 5#	001-63-030-64555	001-63-030-64555	001-63-030-65555
	Nameplate accuWAVE NTC 5 lb.	001-63-034-88555	001-63-034-75555	001-63-034-76555
	Nameplate accuWAVE TC 5 lb.	001-63-034-89555	001-63-034-79555	001-63-034-80555
20	Drive Screws (Nameplate) 2 x 1/8"	903003	903003	903003
21	Seal Wire	001-63-057-50000	001-63-057-50000	001-63-057-50000
	Lead Seal	001-60-157-00000	001-60-157-00000	001-60-157-00000

Parts List

Models MR-8, R-275, R-315 Residential Gas Meters



Illustration Number	Part Description	Part Number MR-8	Part Number R-275	Part Number R-315
22	Index CR 2 ft.- 1/2 ft. Proving Hands NTC		001-63-539-05000	001-63-593-05000
	Index DR 2 ft.- 1/2 ft. Proving Hands NTC		001-63-538-68000	001-63-538-68000
	Index CR 2 ft.- 1/2 ft. Proving Hands TC		001-63-539-15000	001-63-539-15000
	Index DR 2 ft. - 1/2 ft. Proving Hand TC		001-63-538-69000	002-63-539-69000
	Index DR 1 ft. Proving Hand 4 Wheel NTC		001-63-538-66000	001-63-538-66000
	Index DR 1 ft. Proving Hand 4 Wheel TC		001-63-538-67000	001-63-538-67000
	Index .05 m ³ TC 6 Wheel	001-63-538-65000		
Index .05 m ³ NTC 6 Wheel	001-63-538-64000			
23	Index Mounting Screws (#6-32 x 1/2" Fillister Head) All Brass	919656	919656	919656
23A	Index Mounting Screws (#6-32 x 5/8" Fillister Head) All Plastic	919657	919657	919657
23B	Spacer for Brass D.R. Index	001-60-197-61000	001-60-197-61000	001-60-197-61000
24	Index Box Gasket (Cork Rubber)	001-63-170-02000	001-63-170-02000	001-63-170-02000
25	Rockseal	001-63-056-05000	001-63-056-05000	001-63-056-05000
26	Index Box, Molded Lexan with vents	001-63-006-05000	001-63-006-05000	001-63-006-05000
27	Index Box Seal Screw (#10-24 x 11/16" Fillister Head Steel, Drilled)	001-63-056-06000	001-63-056-06000	001-63-056-06000
28	Index Box Screw (#10-24 x 11/16" Fillister Head Steel)	950525	950525	950525
30	Diaphragm Assembly Right Hand (Synthetic) Standard "EB"	001-63-551-72000	001-63-551-72000	001-63-551-72000
	Diaphragm Assembly Left Hand (Synthetic) Standard "EB"	001-63-651-72000	001-63-651-72000	001-63-651-72000
	Diaphragm Assembly Right Hand accuWAVE	001-63-551-75000	001-63-551-75000	001-63-551-75000
	Diaphragm Assembly Left Hand accuWAVE	001-63-651-75000	001-63-651-75000	001-63-651-75000
31	Diaphragm Bracket Rivet (.098 x 5/32")			
32	Diaphragm Bracket			
33	Diaphragm Disc, Outer			
34	Diaphragm			
35	Diaphragm Disc, Inner			
	Diaphragm and Disc Assembly			
36	Diaphragm Pan Assembly Right Hand			
	Diaphragm Pan Assembly left Hand			
37	Diaphragm Clamping Ring			
38	Cover Gasket C.R.	001-63-164-50000	001-63-164-50000	001-63-164-50000
39	Valve Plate (See Valve Plate and Seat Assembly, Item 65)			
40	Index Shaft Worm Wheel	001-63-035-05000	001-63-035-01000	001-63-035-01000
42	Index Shaft Only	001-63-054-08000	001-63-054-03000	001-63-054-03000
43	Diaphragm Screws (#10-24 x 1" Fillister Head Machine w/washer	001-63-119-00000	001-63-119-00000	001-63-119-00000
44	Valve Seat (See Valve Plate and Seat Assembly, Item 65)			
45	Valve Guide	001-63-114-00000	001-63-114-00000	001-63-114-00000
46	Valve Seat Screws (#10-24 x 7/16" Type I Cross Recessed Pan)	950652	950652	950652
47	Exhaust Seal Washer	001-63-134-00000	001-63-134-00000	001-63-134-00000
48	Valve (RH LH) KIT (Bakelite)	001-63-405-04000	001-63-405-04000	001-63-405-04000
50	Plastic Crank and Worm Assembly, NTC	001-63-016-64000	00163-016-62000	00163-016-62000
	Plastic Crank and Worm Assembly, TC	001-63-016-63000	001-63-016-61000	001-63-016-61000
	Crank and Bracket Assembly, NTC	001-63-504-89000	001-63-504-88000	001-63-504-88000
	Crank and Bracket Assembly, TC	001-63-504-97000	001-63-504-91000	001-63-504-91000
50A	Crank Bushing (Powdered Iron)		001-60-065-03000	001-60-065-03000
51	Valve Link (Plastic Crank)	001-63-022-05000	001-63-022-05000	001-63-022-05000
52A	Crank Bracket Screw (#8-32 x 7/16" Fillister Head Machine)	919704	919704	919704
52B	Crank Bracket (Plastic Crank)	001-63-104-02000	001-63-104-02000	001-63-104-02000

(continued on back cover)

Parts List

Models MR-8, R-275, R-315 Residential Gas Meters



Authorized Distributor:

805 Liberty Boulevard
 DuBois, PA 15801
 800-375-8875
 Fax: (814) 375-8460
www.sensus.com/gas

Illustration Number	Part Description	Part Number MR-8	Part Number R-275	Part Number R-315
53	Tangent Assembly, NTC (Includes 53D, 57)	001-61-513-22000	001-61-513-22000	001-61-513-22000
	Tangent Post, NTC and TC	001-63-045-03000	001-63-045-03000	001-63-045-03000
	Tangent Lock Nut	001-61-266-00000	001-61-266-00000	001-61-266-00000
	Tangent Locknut, Thin	001-63-266-03000	001-63-266-03000	001-63-266-03000
	Tangent Adjusting Screw	001-63-046-00000	001-63-046-00000	001-63-046-00000
	Tangent Arm	001-63-013-02000	001-63-013-02000	00163-013-02000
53A	Tangent Assembly, TC			
	53C, 53B, 57, 53D	001-63-513-08000	001-63-513-08000	001-63-513-08000
53B	Tangent Mounting Block, TC	001-63-294-05000	001-63-294-05000	001-63-294-05000
53C	Tangent Mounting Block Screws, TC			
	(#3-56 x 3/16" Binder Head, Stainless Steel)	950433	950433	950433
53D	Bushing	001-63-048-01000	001-63-048-01000	001-63-048-01000
54	Washer Brass	951487	951487	951487
56	Flag Arm and Link Assembly Right Hand (Includes 57, 58, 59)	001-63-511-04000	001-63-511-02000	001-63-511-02000
	Flag Arm and Link Assembly left Hand (Includes 57, 58, 59)	001-63-611-04000	001-63-611-02000	001-63-611-02000
57	Flag Arm Snap Ring	902439	902439	902439
58	Tangent Links Nylon	00163-020-03000	001-63-020-02000	001-63-020-02000
59	Flag Arm and Stud Right Hand	001-63-211-00000	001-63-211-00000	001-63-211-00000
	Flag Arm and Stud left Hand	001-63-311-00000	001-63-311-00000	001-63-311-00000
60	Flag Rod Retaining Clips	904680	904680	904680
61	Flag Rod Gland (Upper)	001-63-012-01000	001-63-012-01000	001-63-012-01000
61A	Flag Rod Gland (Lower)	001-60-012-02000	001-60-012-02000	001-60-012-02000
62	Flag Rod Seal (V Seal)	001-63-276-00000	001-63-276-00000	001-63-276-00000
63	Flag Right Hand	001-63-142-06000	001-63-142-06000	001-63-142-06000
	Flag left Hand	001-63-342-06000	001-63-342-06000	001-63-342-06000
65	Valve Plate and Seat Assembly (Includes 39, 44, 50A, 61, 61A, 62)	001-63-602-13000	001-63-602-13000	001-63-602-13000
	Spacer Bushing Rockseal	001-63-053-01000	001-63-053-01000	001-63-053-01000
66	Spacer Bushing Rockseal	001-63-053-01000	001-63-053-01000	001-63-053-01000
67	Snap Cup Rockseal	001-63-057-02000	001-63-057-02000	001-63-057-02000
68	Tangent Screw to Crank	951509	951509	951509

Part Description	Part Number MR-8	Part Number R-275	Part Number R-315
Crank and Bracket Assembly, NTC Test		001-63-504-31000	001-63-504-31000
Crank and Bracket Assembly, TC Test	001-63-504-24000	001-63-504-36000	001-63-504-36000
Stuffing Box Gear (20T)		001-63-086-08000	
Stuffing Box Gear (30T)	001-63-086-16000		
Test Meter Index	001-63-538-93000	001-63-537-83000	

Limited Warranty

Seller warrants the Goods to be free from defects in materials manufactured by Seller and in Seller's workmanship for a period of one (1) year after tender of delivery (the "Warranty Period"). THIS LIMITED WARRANTY (a) IS IN LIEU OF, AND SELLER DISCLAIMS AND EXCLUDES ALL OTHER WARRANTIES, STATUTORY, EXPRESS OR IMPLIED, INCLUDING, WITH LIMITATION, ANY WARRANTY OF MERCHANTABILITY OR FITNESS FOR A PARTICULAR PURPOSE, OR OF CONFORMITY TO MODELS OR SAMPLES; (b) does not apply to any Goods which have been (i) repaired, altered or improperly installed; (ii) subjected to improper use or storage, (iii) used or incorporated with other materials or equipment, after buyer or anyone using the Goods has, or reasonably should have, knowledge of any defect or nonconformance of the Goods; or (iv) manufactured, fabricated or assembled by anyone other than Seller, (c) shall not be effective unless buyer notifies Seller in writing of any purported defect or nonconformance with (thirty days) after Buyer discovers or should have reasonably discovered such purported defect or nonconformance; and (d) shall only extend to Buyer and not to any subsequent buyers or users of the Goods. Buyer shall provide Seller access to the Goods as to which Buyer claims a purported defect or nonconformance, upon request by Seller, buyer shall, at its own risk and expense, promptly return the Goods in question to Seller's Plant.