

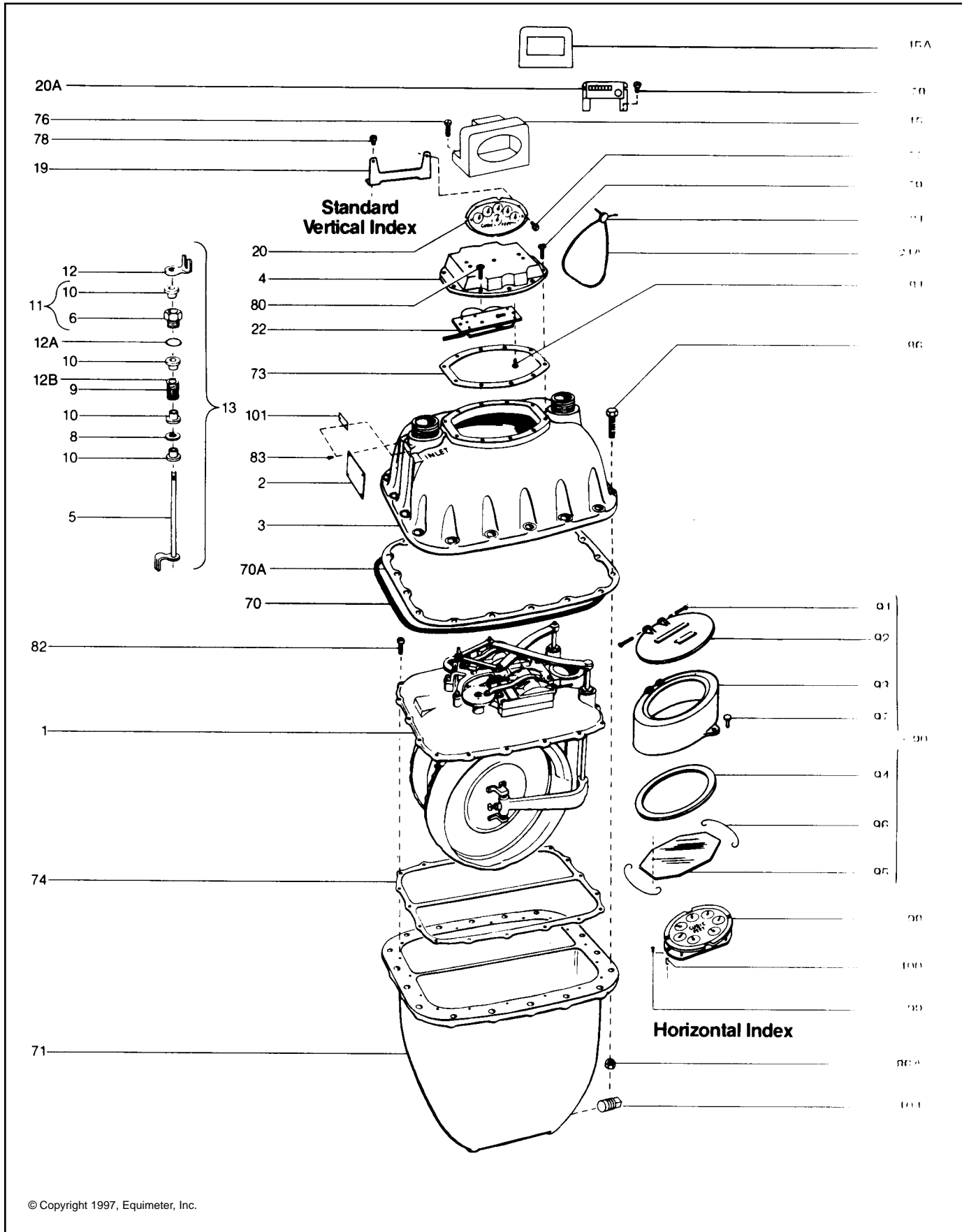

Parts List
Models 750 and 1600
Intermediate Capacity Gas Meters

Parts List
MODELS 750 and 1600
Intermediate Capacity Gas Meters

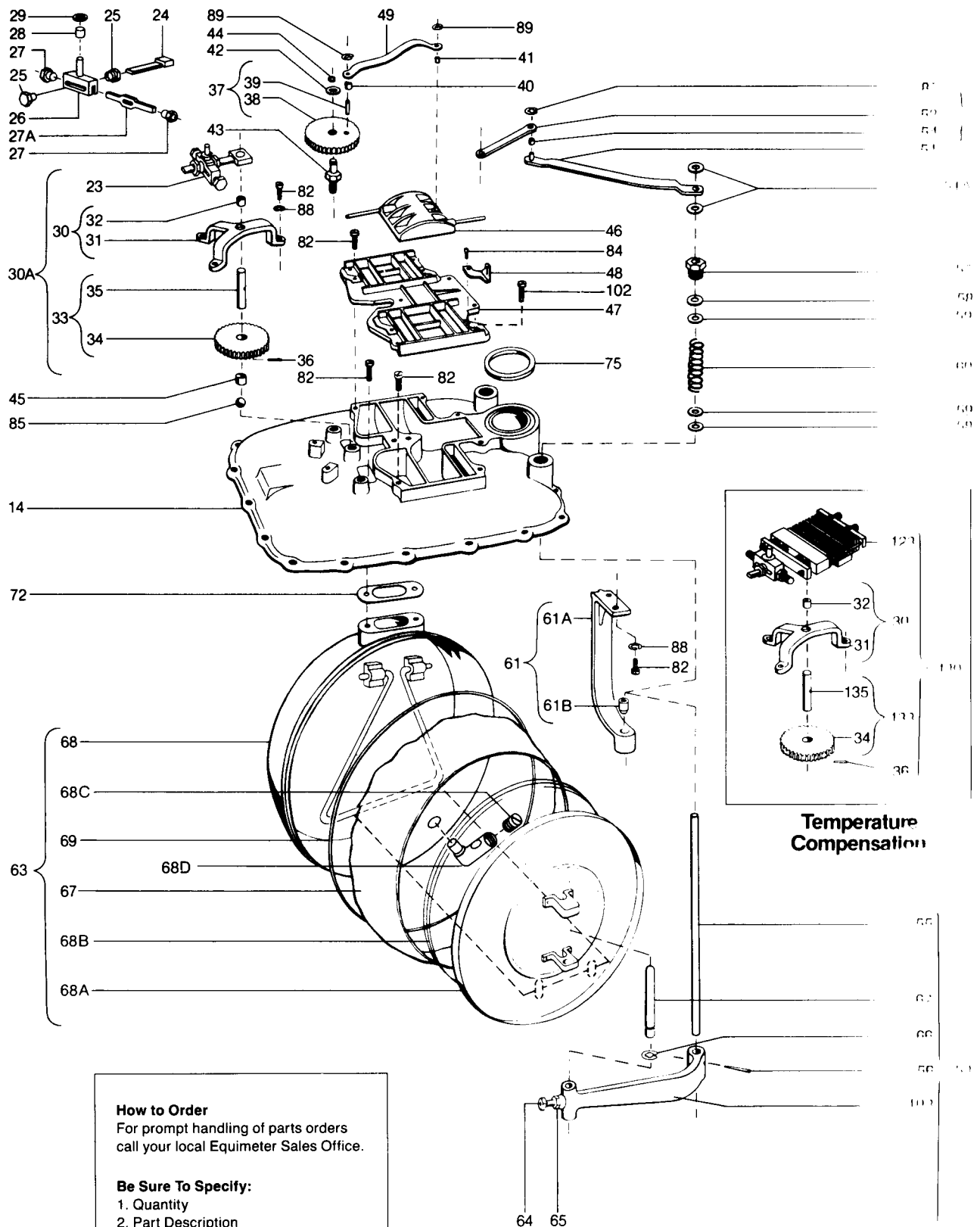



How to Order
 For prompt handling of parts orders
 call your local Equimeter Sales Office.

- Be Sure To Specify:**
1. Quantity
 2. Part Description
 3. Part Number
 4. Size



A member of the BTR Group

Models 750 and 1600 Intermediate Capacity Gas Meters

ILLUSTRATION NUMBER	DESCRIPTION	PART NUMBER
1	750 Valve Plate Assembly, Standard, Without Drains	011-14-502-84
	750 Valve Plate Assembly, Standard, With Drains	011-14-502-86
	750 Valve Plate Assembly, Temperature Compensated, Without Drains	011-14-502-85
	750 Valve Plate Assembly, Temperature Compensated, With Drains	011-14-502-87
	1600 Valve Plate Assembly, Standard, Without Drains	011-14-502-71
	1600 Valve Plate Assembly, Standard With Drains	011-14-502-72
	1600 Valve Plate Assembly, Temperature Compensated, Without Drains	011-14-502-70
2	1600 Valve Plate Assembly, Temperature Compensated, With Drains	011-14-502-73
	Name Plate, Non-Temperature Compensated	011-14-073-XX
3	Name Plate, Temperature Compensated	011-14-073-XX
	750 Cover Assembly, 1 1/2" Pipe Tap	011-14-503-10
	750 Cover Assembly, 60 Lt.	011-14-503-11
	750 Cover Assembly, #3 Sprague	011-14-503-12
	750 Cover Assembly, 45 Lt.	011-14-503-13
	750 Cover Assembly, 30 Lt.	011-14-503-14
	750 Cover Assembly, 1 1/2" Pipe Tap, Tapped for Temperature Well	011-14-503-50
	750 Cover Assembly, 60 Lt., Tapped for Temperature Well	011-14-503-51
	750 Cover Assembly, #3 Sprague, Tapped for Temperature Well	011-14-503-52
	750 Cover Assembly, 45 Lt., Tapped for Temperature Well	011-14-503-53
	750 Cover Assembly, 30 Lt., Tapped for Temperature Well	011-14-503-54
	1600 Cover Assembly, 1 1/2" Pipe Tap	011-14-403-06
	1600 Cover Assembly, 60 Lt.	011-14-403-07
	1600 Cover Assembly, #3 Sprague	011-14-403-08
	1600 Cover Assembly, 45 Lt.	011-14-403-09
	1600 Cover Assembly, 30 Lt.	011-14-403-10
	1600 Cover Assembly, 1 1/2" Pipe Tap, Tapped for Temperature Well	011-14-403-45
	1600 Cover Assembly, 60 Lt., Tapped for Temperature Well	011-14-403-46
	1600 Cover Assembly, #3 Sprague, Tapped for Temperature Well	011-14-403-47
	1600 Cover Assembly, 45 Lt., Tapped for Temperature Well	011-14-403-48
1600 Cover Assembly, 30 Lt., Tapped for Temperature Well	011-14-403-49	
4	750 Index Plate Assembly, for 5' or 10' Index	011-14-504-00
	1600 Index Plate Assembly, for 5' or 10' Index	011-14-504-25
5	Index Shaft & Dog Assembly	011-14-554-02
6	Index Shaft Gland (Order With Item 11)	002-22-023-00
8	Index Shaft Washer, Brass	011-61-062-01
9	Index Shaft Spring	001-61-121-00
10	Index Shaft Bushing (Order With Item 11)	001-60-052-62
11	Index Shaft Gland & Bushing Assembly (Including Items 10 & 6)	002-22-323-02
12	Index Shaft Dog	002-66-071-08
12A	"O" Ring	904379
12B	Seakant	950767
13	Stuffing Box Assembly Less Index Plate	011-14-423-01
14	Valve Plate Only (1600 Only)	011-14-002-01
†14A	Valve Plate & Seat Assembly (1600 Only)	011-14-402-04
15	Index Box, Circular Reading	011-14-006-10
15A	Index Box, Direct Reading	011-14-006-15
19	Index Bracket	005-68-118-02
20	Index Assembly, Circular Reading, 5' Proving Circle, Vertical	002-20-537-05
	Index Assembly, Circular Reading, 10' Proving Circle, Vertical, 6 Circles	002-20-537-10
	Index Assembly, Circular Reading, 10' Proving Circle, Vertical, 5 Circles	002-20-537-72
20A	Index Assembly, Direct Reading, 5' Proving Circle, Vertical	011-14-637-00
	Index Assembly, Direct Reading, 10' Proving Circle, Vertical	011-14-637-01
21	Lead Seal	001-60-157-00
21A	Seal Wire	002-66-057-11
*22	750 Intermediate Gear (13:1 Ratio) For Use With 5' Index	011-14-412-03
	750 Intermediate Gear (26:1 Ratio) For Use With 10' Index	001-14-412-07
**22	1600 Intermediate Gear (13:1 Ratio) For Use With 5' Index	002-20-412-01
	1600 Intermediate Gear (26:1 Ratio) For Use With 10' Index	011-14-412-06
*22A	750 Intermediate Gear (9:1 Ratio) For Use With .1m ³ Index	011-14-412-00
**22A	1600 Intermediate Gear (9:1 Ratio) For Use With .1m ³ Index	011-14-412-01
23	Tangent Assembly (Includes Items 28 & 29)	011-14-513-13
24	Tangent Arm	002-65-013-02
25	Tangent Arm Locknut	002-66-015-07

* Used for 750 Meters with Serial No. W-39323 and later and 1600 Meters built from and including Serial No. N-35305 to N-79118 ("O" Ring).

** Used for 750 Meters prior to Serial No. W-39323, Standard 1600 Meters ("O" Ring) and 1600 Meters built prior to Serial No. N-35305.

† Not illustrated. Includes Illustration Numbers 14, 45, 47, 82 and 102.

Models 750 and 1600 Large Capacity Gas Meters

ILLUSTRATION NUMBER	DESCRIPTION	PART NUMBER
26	Tangent Post	011-14-045-05
27	Tangent Adjusting Screw	002-66-015-05
27A	Tangent Post Adjusting Screw	002-65-046-00
28	Tangent Post Bushing	002-65-048-07
29	Retaining Ring, Waldes Truarc #5133-25 S.M.F.	904680
30	Tangent Gear Bracket Assembly	011-14-404-01
30A	Tangent Gear, Bracket and Tangent Assembly, Standard (Includes Items 28 & 29)	011-14-604-07
31	Tangent Gear Bracket Only	011-14-104-00
32	Tangent Gear Bracket Bushing	011-14-108-03
33	Tangent Gear Assembly	011-14-561-36
34	Tangent Gear Only	011-14-061-23
35	Tangent Gear Post	011-14-016-05
36	Tangent Gear Groove Pin, $\frac{3}{32}$ " Diameter x $\frac{3}{4}$ " Long (Type 5)	904116
37	Valve Gear Assembly	011-14-561-10
38	Valve Gear Only	011-14-061-15
39	Valve Gear Stud	011-14-062-03
40	Valve Gear Stud Bushing	011-14-114-02
41	Valve Stud Bushing	011-14-115-02
42	Valve Gear Post Washer	002-65-018-02
43	Valve Gear Post	011-14-064-02
44	Gear Post Snap Ring	906687
45	Tangent Gear Post Bushing	011-14-287-03
46	Valve Assembly, Right Hand or Left Hand	011-14-505-26
47	Valve Seat	011-14-106-00
48	Valve Guide (4)	011-14-069-03
49	Valve Links	011-14-022-02
50	Flag Arm & Link Assembly, Right Hand	011-14-511-02
	Flag Arm & Link Assembly, Left Hand	011-14-611-02
51	Flag Arm & Stud Assembly, Right Hand	011-14-111-02
	Flag Arm & Stud Assembly, Left Hand	011-14-311-02
51A	Flag Arm Position Plate	011-14-285-00
52	Tangent Link	011-14-020-00
53	Flag & Rod Assembly, Right Hand	011-14-542-01
	Flag & Rod Assembly, Left Hand	011-14-642-01
54	Flag Arm Stud Bushing	011-14-117-02
55	Flag Rod Only, Right Hand	011-14-141-00
	Flag Rod Only, Left Hand	011-14-341-00
56	#0 x 1" Long Steel Taper Pin	931401
57	Flag Rod Packing Gland	011-14-512-02
58	Flag Rod Stuffing Box Washer	011-14-180-00
59	Flag Rod Stuffing Box Washer, Brass	011-14-049-02
60	Flag Rod Stuffing Box Spring	002-67-021-00
61	Flag Rod Bracket Assembly	011-14-202-03
61A	Flag Rod Bracket	011-14-102-02
61B	Flag Rod Bracket Bearing	011-14-284-03
62	Rocker Shaft	011-14-147-03
	Diaphragm Assembly, Right Hand or Left Hand, Synthetic Without Drains	011-14-550-74
63	Diaphragm Assembly, Right Hand, Synthetic With Drains	011-14-550-75
	Diaphragm Assembly, Left Hand, Synthetic With Drains	011-14-650-75
64	$\frac{1}{4}$ -20 x $\frac{1}{2}$ " Long Cup Point Stainless Steel Set Screw (Flag), Hex Socket Head	903508
65	$\frac{1}{4}$ -20 Stainless Steel Jam Nut	950101
66	Waldes Truarc "E" Retaining Ring (Rocker Shaft)	904689
67	Diaphragm Fabric, Synthetic	011-14-150-71
	Outer Diaphragm Pan Assembly	011-14-525-06
68	Outer Diaphragm Pan Assembly, Right Hand, With Drains	011-14-525-07
	Outer Diaphragm Pan Assembly, Left Hand, With Drains	011-14-625-06
68A	Inner Diaphragm Pan Assembly (Includes Guide Wire)	011-14-526-05
68B	Binding Wire	99942
68C	Drain Valve	002-66-188-05
68D	Drain	011-14-195-00
69	Diaphragm Clamping Band Assembly	011-14-581-21
70	1600 Cover Gasket ("O" Ring)	011-14-164-05



A member of the BTR Group

Models 750 and 1600 Intermediate Capacity Gas Meters

ILLUSTRATION NUMBER	DESCRIPTION	PART NUMBER
70 A	750 Cover Gasket	001-14-164-12
71	750 Body, Without Drains	011-14-301-10
	750 Body With Drains	011-14-301-11
	1600 Body, Without Drains	011-14-301-04
	1600 Body, With Drains	011-14-301-05
72	750 & 1600 Diaphragm Port Gasket	011-14-171-00
73	750 Index Plate Gasket	011-14-172-00
	1600 Index Plate Gasket	011-14-172-04
74	Valve Plate Gasket	011-14-163-00
75	Outlet Channel Seal Gasket	011-14-286-00
76	Index Box Seal Screws For Equimeter Box	002-20-056-02
	Index Box Seal Screws For Carolina Molding Box	950053
77	8-32 x 3/16" Round Head Machine Screw, Steel	914450
78	5/16-18 x 3/8" Filister Head Machine Screw, Steel	919900
79	Index Plate Seal Screws	002-65-057-02
80	5/16-18 x 3/4" Hex Head Cap Screw, Steel	910028
81	Intermediate Gear Screw With Lockwasher	903461
82	1/4-20 x 5/8" Filister Head Machine Screw, Steel	919854
83	#4 x 3/16" Round Head Drive Screw (Type U)	906288
84	#8-32 x 1/4" Round Head Machine Screw, Steel	914451
85	Ball Bearing, 5/16" Diameter Stainless Steel	930508
86	5/16-18 x 1 1/4" Hex Head Cap Screw, Steel Grade 5 (750 Only)	910031
	3/8-16 x 1 3/4" Hex Head Cap Screw, Steel Grade 5 (1600 Only)	910058
86 A	5/16-18 Heavy Hex Nut, Steel Grade 5 (750 Only)	903859
	3/8-16 Heavy Hex Nut, Steel Grade 5 (1600 Only)	920853
87	Waldes Truarc "E" Retaining Ring (Flag Arm)	904680
88	Lockwasher, 1/4" Med. Helical Spring, Steel	932525
89	Waldes Truarc "E" Retaining Ring (Valve Stud) #5133-18 ZD	904679
90	Horizontal Index Box Assembly	002-65-506-12
91	Round Head Copper Rivet	904145
92	Index Box Cover	002-65-007-08
93	Index Box	002-65-006-09
94	Index Box Gasket	002-65-283-00
95	Index Box Glass	002-65-162-00
96	Index Box Glass Retainer	001-60-008-00
97	Index Box Seal Screw	002-65-056-00
98	Horizontal Index, 10'	002-65-537-00
99	8-32 x 1" Round Head Machine Screw, Steel	914459
100	Spacing Sleeve (Horizontal Index)	002-67-197-04
101	Customer's Badge (Blank)	001-61-028-20
102	1/4-20 x 5/8" Flat Head Machine Screw, Steel	919354
103	Flag	011-14-142-02
104	Drain Plug, 1/2-14 Square Head Pipe Plug	923053

Bimetal Temperature Compensated Parts

123	Tangent Assembly, Temperature Compensated	011-14-513-05
130	Tangent Gear, Bracket & Tangent Assembly, Bimetal Temperature Compensated, Complete	011-14-604-06
133	Tangent Gear & Post Assembly	011-14-561-37
135	Tangent Gear Post	011-14-016-07



Equimeter Incorporated
 805 Liberty Boulevard
 P.O. Box 528
 DuBois, PA 15801
 (814) 371-8000
 Fax: (814) 375-8460

A member of the BTR Group



LIMITED WARRANTY Seller warrants the Goods to be free from defects in materials manufactured by Seller and in Seller's workmanship for a period of [one (1) year] after tender of delivery (the "Warranty Period"). **THIS LIMITED WARRANTY (a) IS IN LIEU OF, AND SELLER DISCLAIMS AND EXCLUDES, ALL OTHER WARRANTIES, STATUTORY, EXPRESS OR IMPLIED, INCLUDING, WITHOUT LIMITATION, ANY WARRANTY OF MERCHANTABILITY OR FITNESS FOR A PARTICULAR PURPOSE, OR OF CONFORMITY TO MODELS OR SAMPLES; (b)** does not apply to any Goods which have been (i) repaired, altered or improperly installed; (ii) subjected to improper use or storage; (iii) used or incorporated with other materials or equipment, after Buyer or anyone using the Goods has, or reasonably should have, knowledge of any defect or nonconformance of the Goods; or (iv) manufactured, fabricated or assembled by anyone other than Seller; (c) shall not be effective unless Buyer notifies Seller in writing of any purported defect or nonconformance within [thirty (30) days] after Buyer discovers or should have reasonably discovered such purported defect or nonconformance; and (d) shall only extend to Buyer and not to any subsequent buyers or users of the Goods. Buyer shall provide Seller access to the Goods as to which Buyer claims a purported defect or nonconformance; upon request by Seller, Buyer shall, at its own risk and expense, promptly return the Goods in question to Seller's Plant.